

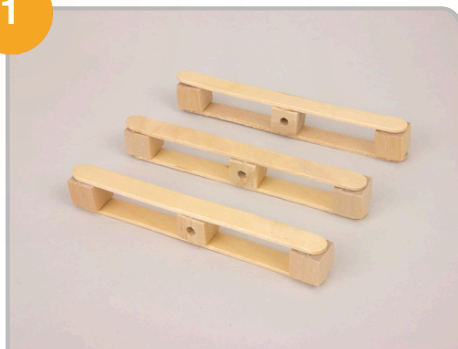

1



1. Glue three sets of sticks, cubes, and cubes with holes as shown.

2

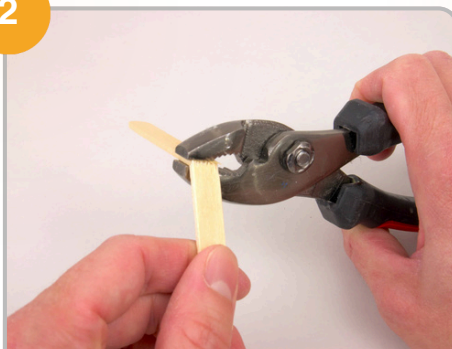

2. Break six craft sticks in half with a pair of pliers.

3



3. Glue the half-sticks into a U-shape with two cubes and two cubes with holes.

4



4. Connect the U-shape and the parts from step 1 with a dowel. Use straw pieces as spacers.

5



5. Trim the dowel and wrap tape around the ends.

6



6. Break more sticks in half and glue them at a 45° angle as shown to extend the fingers.

7



7. Extend the arm as much as you want with cubes and craft sticks.

8



8. Attach another empty syringe. Glue on a cube with holes, or attach a syringe adapter

9



9. Push water through the tubing to remove all of the air



10



10. Refill to 10ml

11



11. Attach another empty syringe. Glue on a cube with holes, or attach a syringe adapter

12

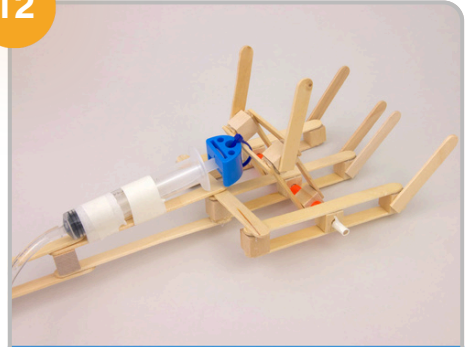

12. Zip tie the adapter to the hand. Open the hand all the way and tape the syringe as shown.

13

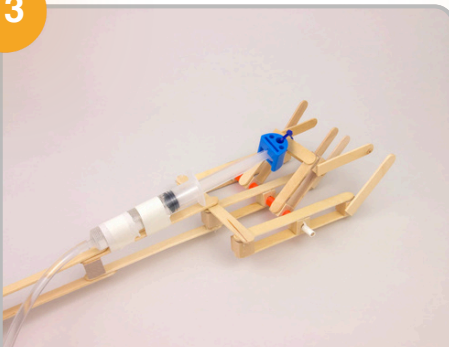

13. Test to make sure the hand closes all the way.

14

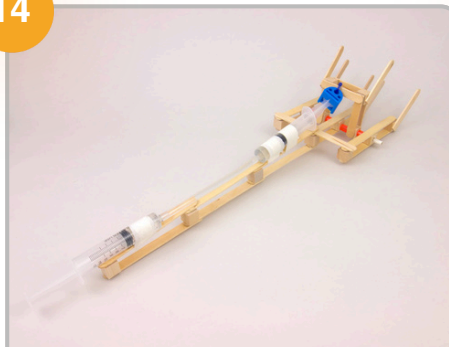

14. Tape the other syringe onto the arm.

15

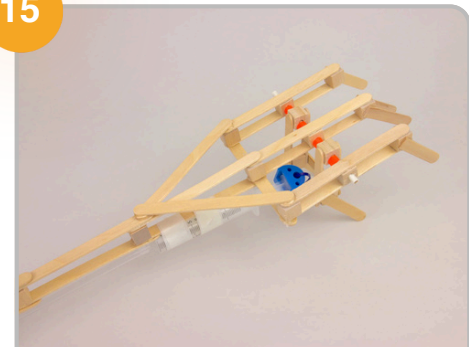

15. Reinforce the hand-to-arm connection with more sticks.

16

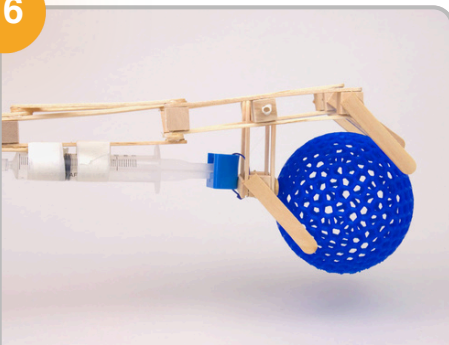

Try picking up objects around your house and modify the hand so it can pick up more things.